

# Z6.300

## SPECIFICATIONS

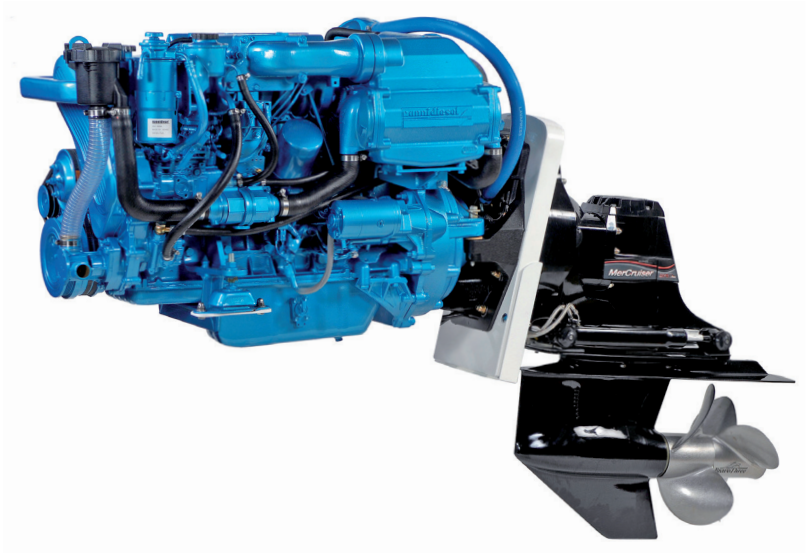

Power at crankshaft	202.4 kW [275 hp]
Displacement	4.2 l [254 in³]
Configuration	6 cylinders in line
Operation type	4 strokes Diesel
Bore & Stroke	94 x 100 mm [3.7 x 3.94 in]
Compression ratio	15.7 : 1
Rated speed	3600 rpm
Idling speed	700 rpm
Peak torque	687 Nm
Peak torque speed	2400 rpm

Engine base	Toyota
Fuel system	Direct injection Mechanical controlled
Air intake	Turbocharged with intercooler
Cooling	Closed cooling with heat exchanger
Max mounting angle	7° Front down 7° Front up
Alternator	12 Volt 80 Amp
Rating	M6
Emission compliance	RCD 94/25/EC BSO2
Dry weight with Bravo X Three	552 kg [1217 lbs]

# Z6.300

202.4 kW [275 hp] at 3600 rpm

## TECHNICAL DESCRIPTION

### ENGINE BLOCK

- 6 Cylinders in line
- 4 Valves per cylinder
- Water-cooled exhaust manifold
- Balancing shafts

### FUEL SYSTEM

- Direct injection, mechanical controlled
- Mechanically primed fuel filter

### LUBRICATION SYSTEM

- Replaceable full-flow oil filter
- Oil dipstick
- Oil cooler

### COOLING SYSTEM

- Closed cooling with heat exchanger
- Gear driven self-priming raw water pump
- Coolant circulating pump
- Water cooled exhaust elbow

### ELECTRICAL SYSTEM & INSTRUMENTATION

- 12 V / 80 A Alternator
- 12 V starter motor
- Complete instrumentation including key switch and alarms
- Extension cable harness with plug-and-play

### AIR INTAKE

- Water-cooled turbocharger
- Intercooler

### OTHER FEATURES

- Flexible engine mounting

### OPTIONAL EQUIPMENTS & ACCESSORIES

- Complete marine propulsion systems
- Marine transmission adaptation kits
- Throttle and shift controls
- Additional instrumentation, Flying bridge extension harness
- Water boiler systems
- Stuffing box connections
- Complete exhaust systems
- Trolling valve
- 12V / 120A alternator
- Two pole electrical system

## RATINGS

- Up to 500 annual operating hours
- Load factor up to 35%
- Full power for no more than 30 minutes out of each 8 hours of operation. The remaining time must be at, or below cruising speed

## TRANSMISSIONS

### STERN DRIVE

- Bravo X One
- Bravo X Two
- Bravo X Three
- Contact your Nanni representative for more details and availability about transmissions types and models range.

## PERFORMANCE CURVES

### POWER AT CRANKSHAFT

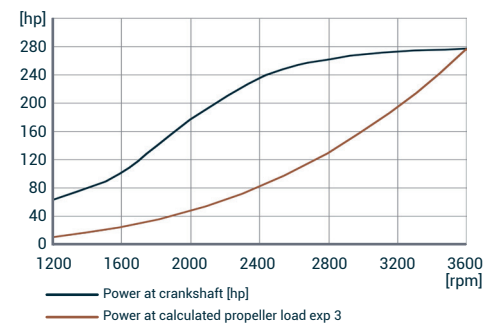

### TORQUE AT CRANKSHAFT

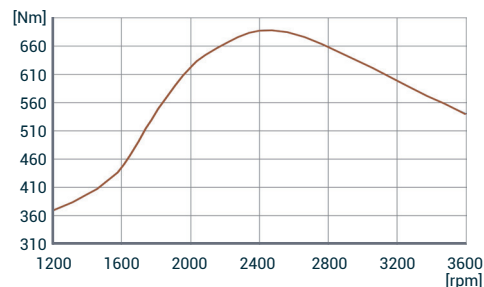

### FUEL CONSUMPTION

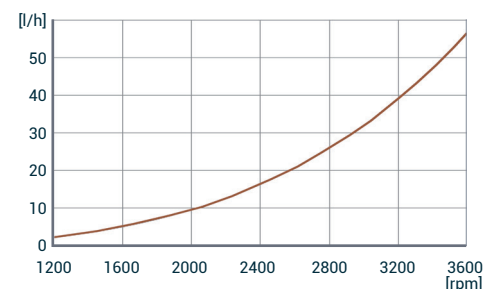

## DIMENSIONS WITH BRAVO X THREE

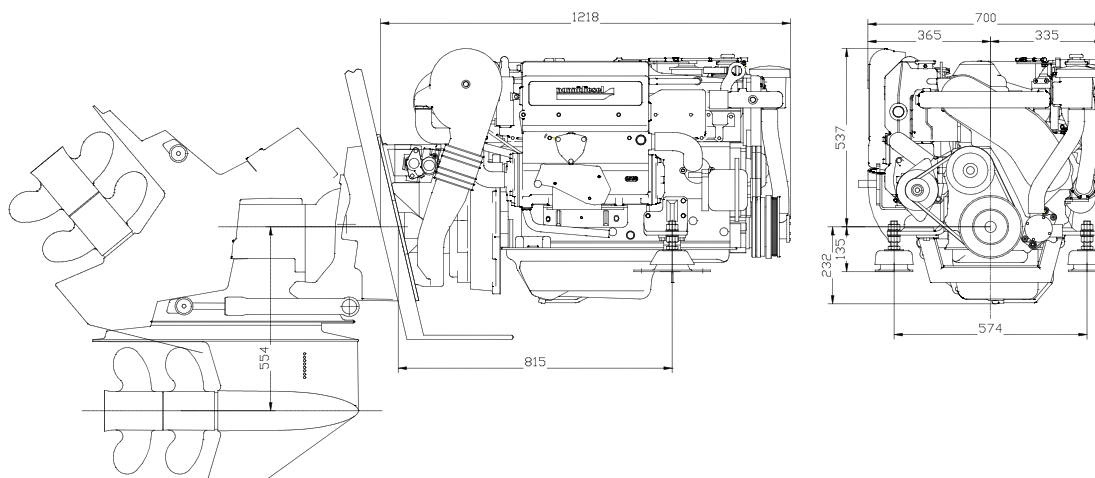

## NANNI INDUSTRIES S.A.S.

11, Avenue Mariotte - Zone Industrielle  
33260 La Teste - France  
Tel: +33 (0)5 56 22 30 60  
Fax: +33 (0)5 56 22 30 79

Technical data according to ISO 8665. This document is not contractual. Nanni reserves the right to modify any of the characteristics stated in this document without notice, in a constant effort to improve the quality of its products. Images and illustrations may show non standard equipments. All combination of equipment & accessory are not available.

DGBXXC01021